

## Single Leaf SEC / ZT-1 Detention Door

Tested according to the VfS planning guideline for detention doors 2016.

### Optional Audited Additional Functions

- Safety especially static and dynamic load in acc. to RC5
- Fire Protection opening in case of fire after 15 minutes
- Smokeproof tightly closing
- Sound Insulation  $R_{w,P}$  37 dB
- Noise Reduction 90 dB(A)
- Function when blocked: opening possible when blocked
- Version for specially secured detention rooms (BGH)
- Stainless Steel

### Range of Dimension

Width from 875 mm to 1250 mm  
Height from 1875 mm to 2250 mm

### Technical Specification and Tender Text

- Product:** SEC / ZT-1 single leaf detention door  
brand Buchele tested acc. to VfS planning guideline
- Door Type:** SEC / ZT-1
- Structural Opening:** .... x .... mm
- Door Leaf:** Double-walled, planar 80 mm thick steel door leaf out of 2,0 mm folded steel sheet without hinge embossing, three sides rebated with thick rebate and sealing profile in the rebate.  
Without bottom stop.  
Special insulating inserts fully laid-in and glued.  
Drop seal system.
- Threshold:** Threshold profile out of steel sheet, top edge flush mounted with the finished floor. Surface galvanized and welded to the frame.  
With spring-loaded floor closing device.
- Frame:** 3-sided circumferential rebated encasing frame out of 3,0 mm folded steel sheet.  
Frame flush mounted with the wall on the cell side.
- Hinges:** 3 pieces of three-part, height adjustable construction hinges with hinge pin retention and ball bearing spacer ring for smooth door movement.  
With anti-hang-out device when the door leaf is open.
- Fitting:** Prepared for installation of a detention lock with integrated deadbolt.  
Locking status indicator.  
**Please note:** The exact lock type must be agreed with Buchele.  
Bow handle out of stainless steel, surface brushed and key rose mounted on hinge side.
- Surface:** Door leaf and frame galvanized und primed with 2K-PUR primer (Very High Solid) similar RAL 7035.

## Supplementary Equipment

<b>Quick Release Fastener:</b>	Concealed shoot bolt lock upwards and downwards as part of the lock with handle lever or as additional lock with handle lever and foot operated mechanism.
<b>Glazing:</b>	P6B single or insulating glazing fixed with profiled glazing bars. Minimum border 125 mm on side and top, base 300 mm.
<b>Functional Fanlight:</b>	Made of shatterproof P6B safety glass for lighting and observation technology.
<b>Food Hatch / Shackle Hatch:</b>	Flush-mounted in the door leaf. Free cross-section 260x200 mm. Flap hinged at the bottom and locked at 90°. Prepared for installation of a detention lock with locking latch and locking status indicator. <b>Please note:</b> The exact lock type must be agreed with Buchele. Key rose mounted on hinge side.
<b>Wide Angel Door Viewer:</b>	Flush-mounted in the door leaf, without screwing on cell side. Installation 1550 mm from top edge of finished floor.
<b>Protective Sheet:</b>	Stainless steel sheet in the area of the lock and handle or along the entire height of the door leaf.
<b>Stainless Steel:</b>	Material 1.4301 (V2A) or 1.4404 (V4A), Surface mill finish or brushed.

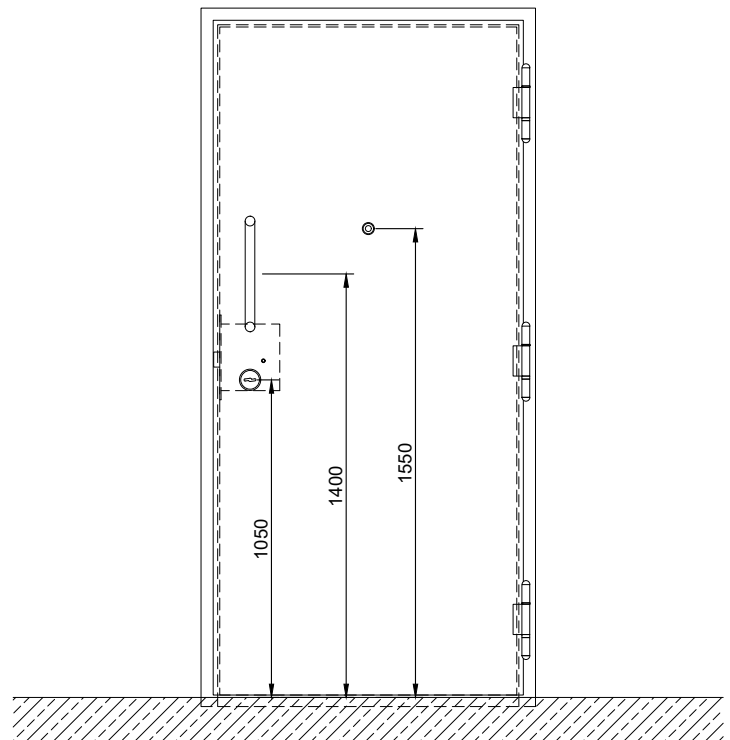
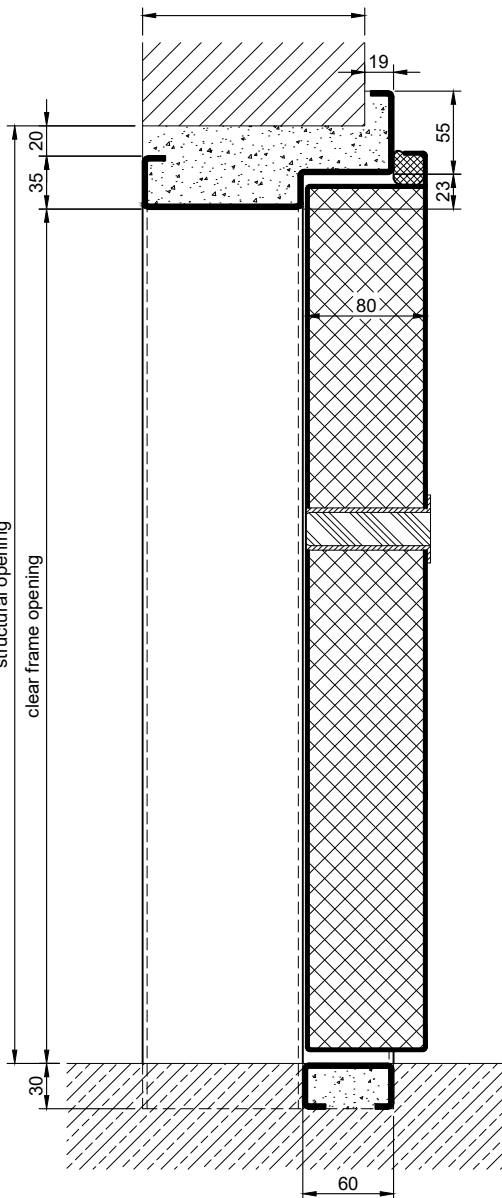
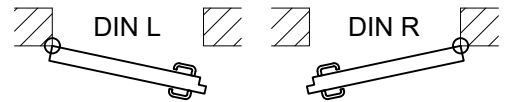
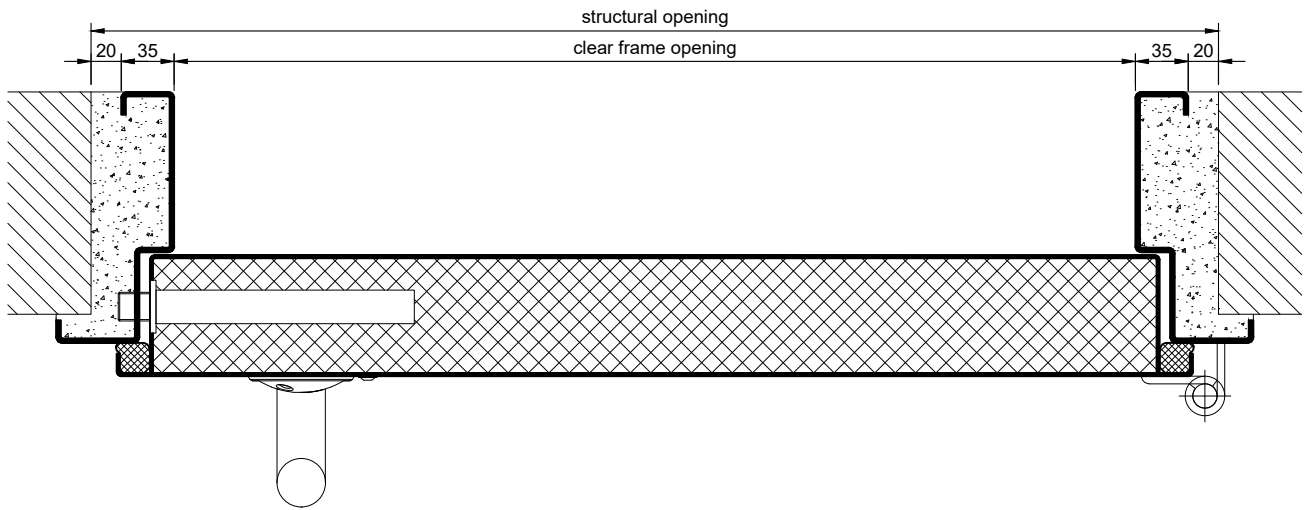

8.0.2\_SEC ZT-1\_EN

technical modifications reserved - edition 07/2024

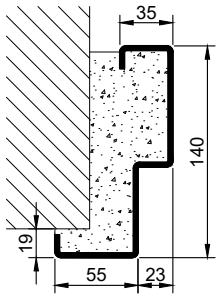
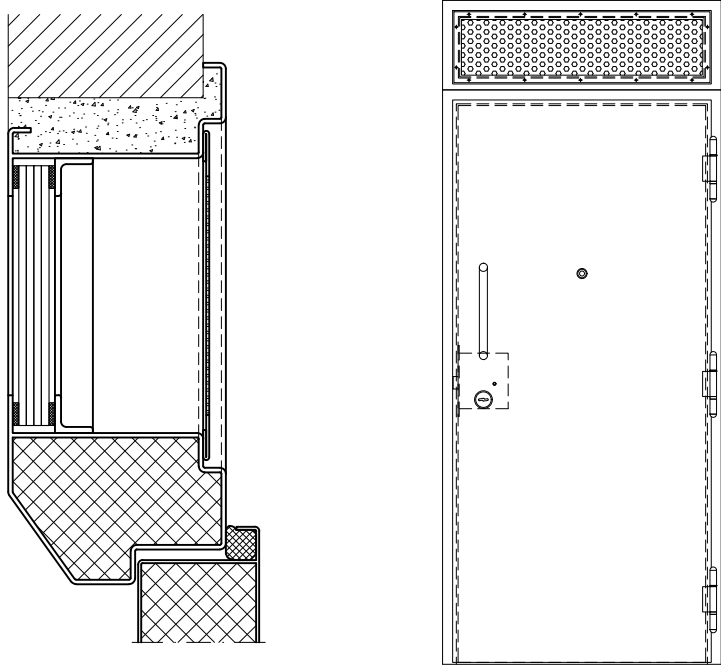
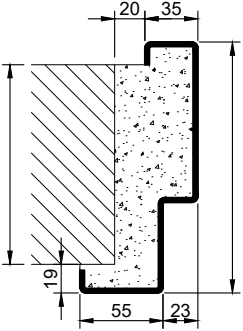
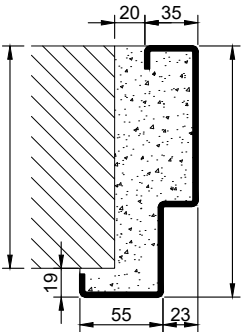
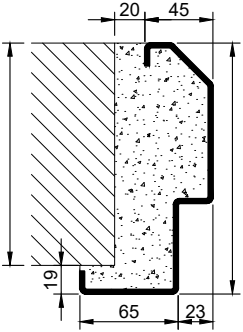
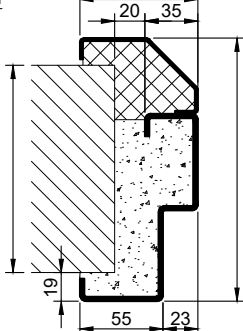
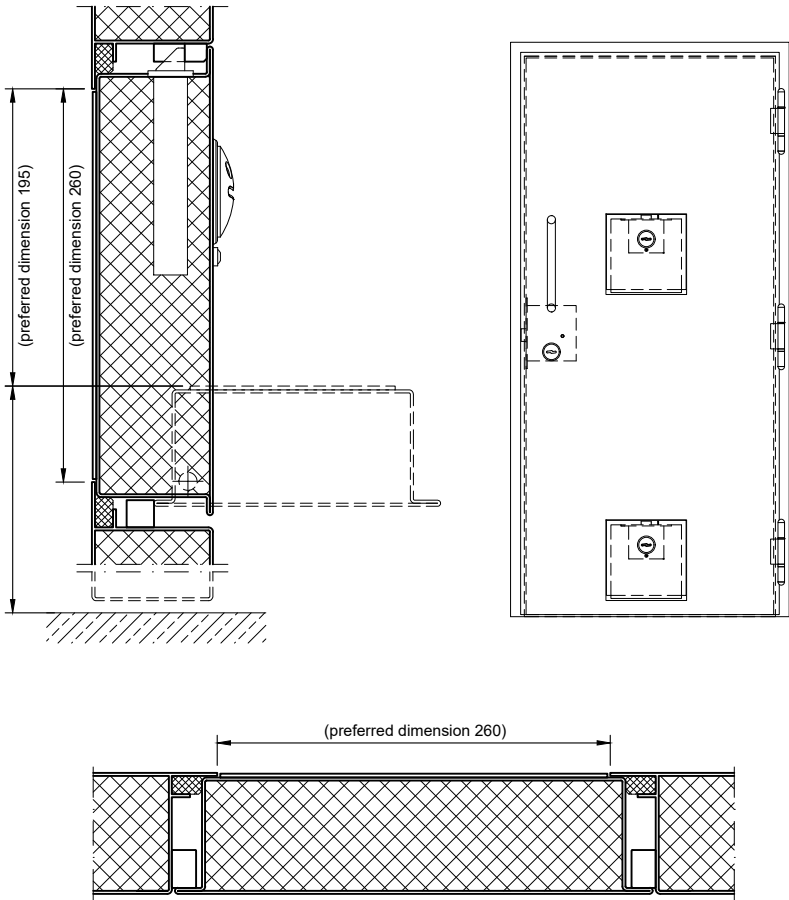
Frames	Functional Fanlight
<p>corner frame</p> 	
<p>encasing frame</p> 	
<p>encasing frame, flush to the wall</p> 	
<p>encasing frame, chamfered</p> 	<p>Food Hatch and/or Shackle Hatch</p>
<p>corner frame with counter frame, chamfered</p> 	

8.0.2\_SEC ZT-1\_EN

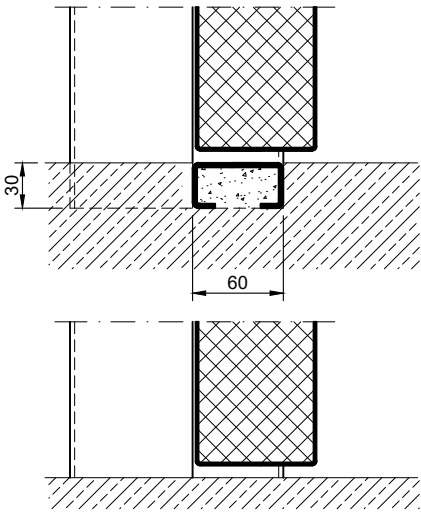
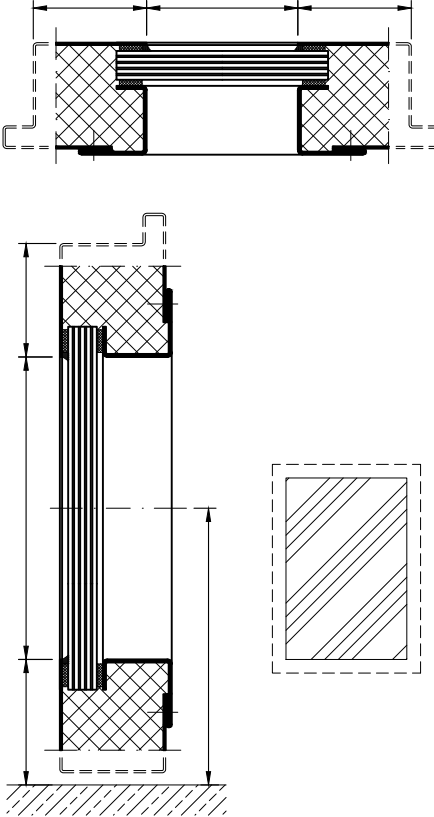
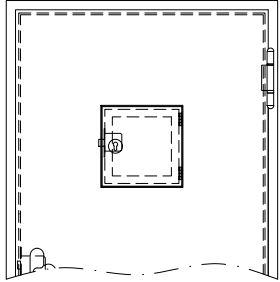
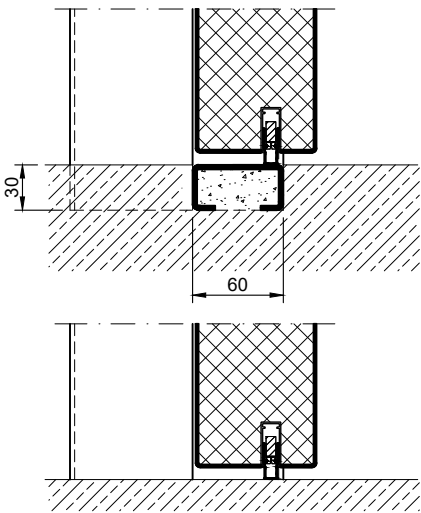
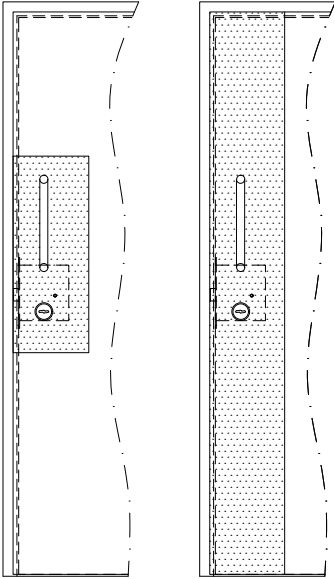
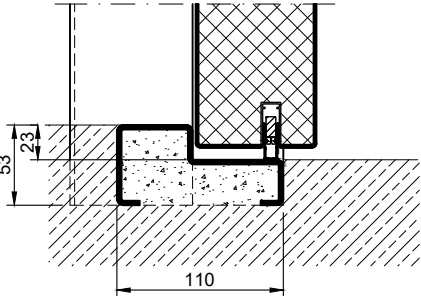
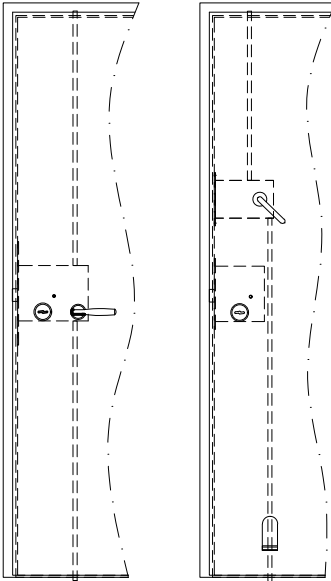
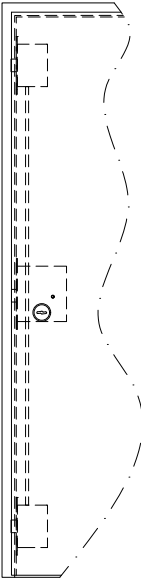
Thresholds	Options	
<p>separation sill</p> 	<p>vision panel</p> 	<p>cover flap for vision panel</p> 
<p>drop seal</p> 		<p>protective sheet</p> 
<p>stop sill with drop seal</p> 	<p>quick release fastener</p> 	<p>multi point locking system</p>  <p>push bolt</p> 