

### Double Leaf Flood Door

#### Water Tight

(water side is hinge side)

up to 3,5 m WS (water column)

### Optional Audited Additional Functions

- Stainless Steel

### Range of Dimension

Width from 1375 mm to 2500 mm

Height from 1500 mm to 2500 mm

### Technical Specification and Tender Text

<b>Product:</b>	HT 50-2 double leaf flood door brand Buchele
<b>Door Type:</b>	HT 50-2
<b>Water Tight:</b>	up to 3,5 m WS (water side is hinge side)
<b>Structural Opening:</b>	.... x .... mm
<b>Door Leaf:</b>	Double-walled, planar 50 mm thick steel door, four sides rebated with special rebate and adjustable fixed sealing profile in the rebate. Door leaf without insulating inserts. Active leaf with sealing profile in the middle rebate.
<b>Frame:</b>	4-sided circumferential rebated corner frame.
<b>Hinges:</b>	Three-part, height adjustable special hinges with adjustment device to the frame.
<b>Fitting:</b>	4-point locking system with rolling pin operated by powerful clamping lever visibly mounted on the opposite hinge side of the door leaf.
<b>Surface:</b>	Door leaf and frame galvanized und primed with 2K-PUR primer (Very High Solid) similar RAL 7035.

### Supplementary Equipment

<b>Stainless Steel:</b>	Material 1.4301 (V2A) or 1.4404 (V4A), Surface mill finish or brushed.
<b>Supplementary Equipment:</b>	Clamping lever can be operated from both sides with watertight sealing in the door leaf.  Deadbolt lock mounted in surface-mounted housing on opposite hinge side (prepared for installation of a profile half-cylinder lock, provided by customer).  Thermally insulated door leaf with PU foam filling.

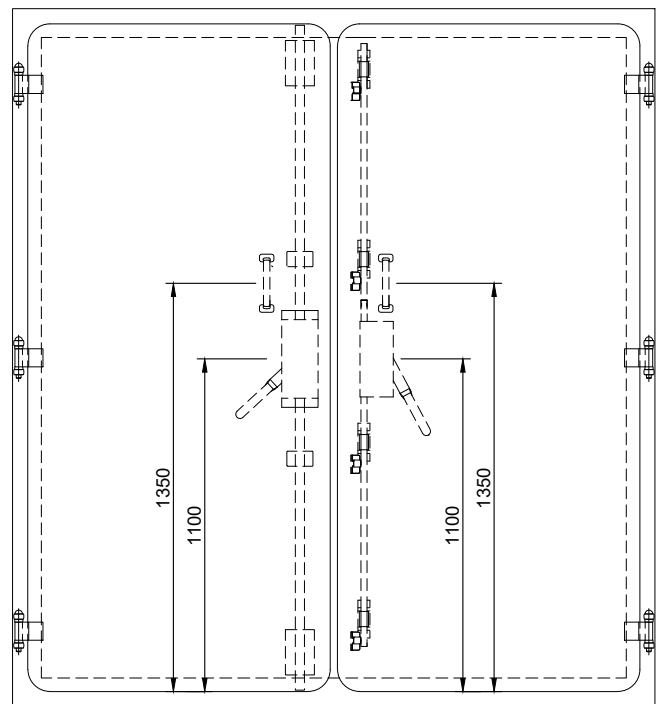
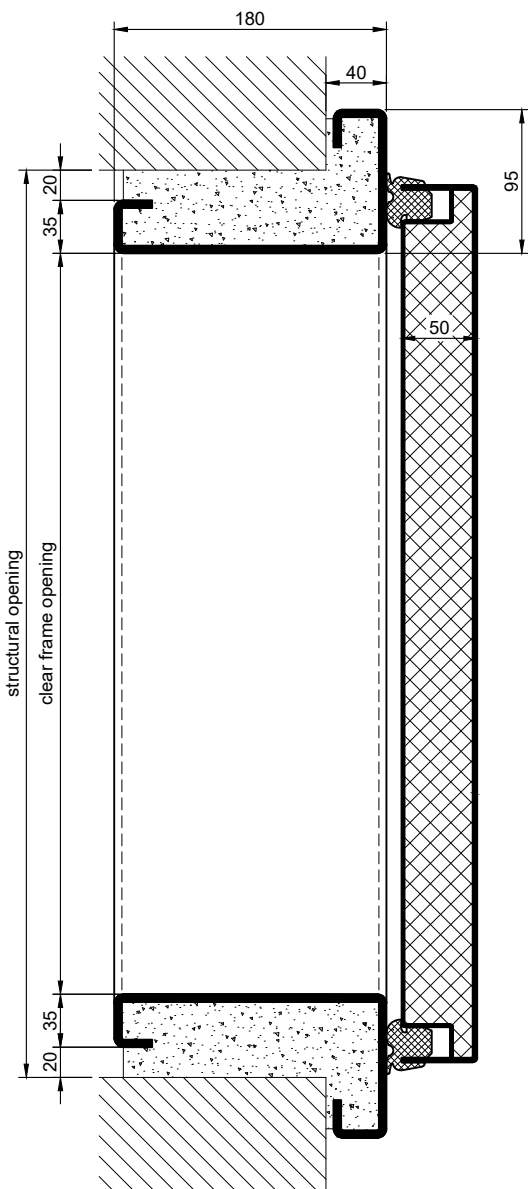
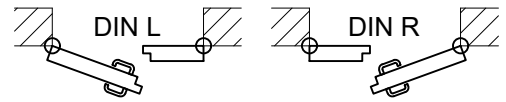
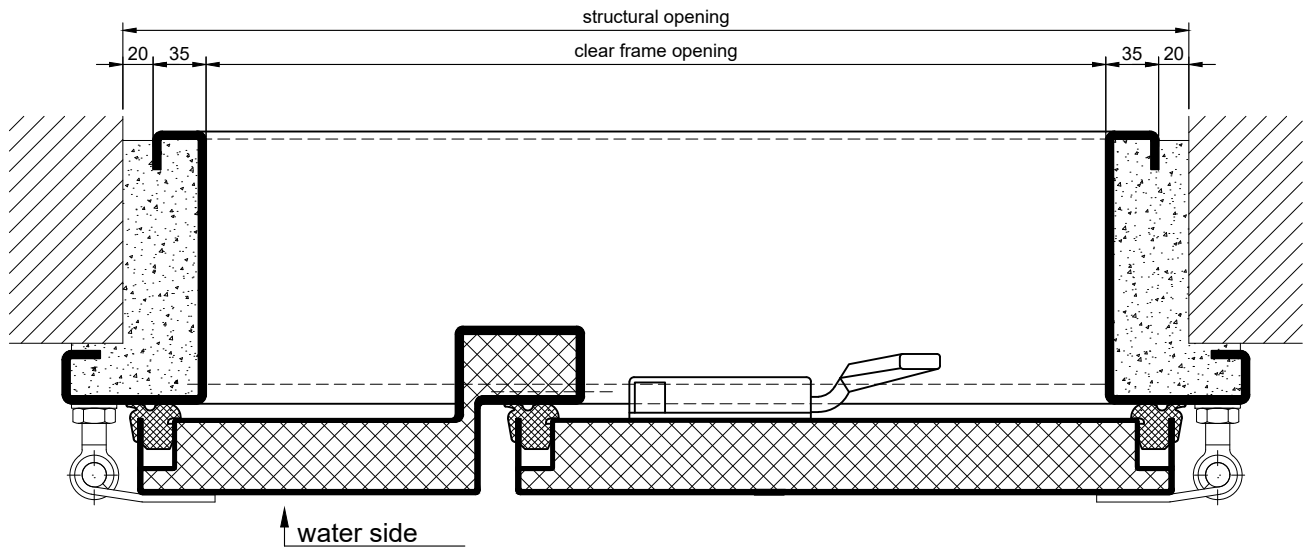

7.20.1-HT 50-2-EN

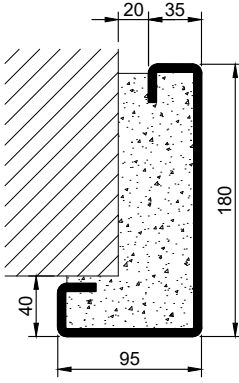
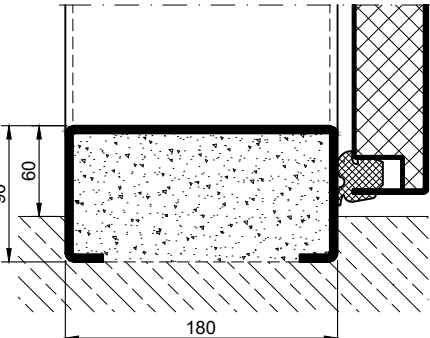
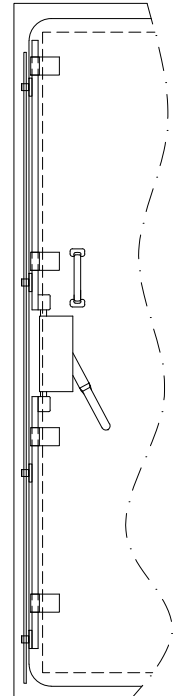
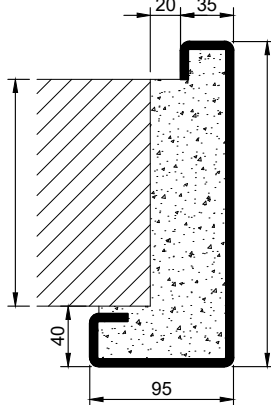
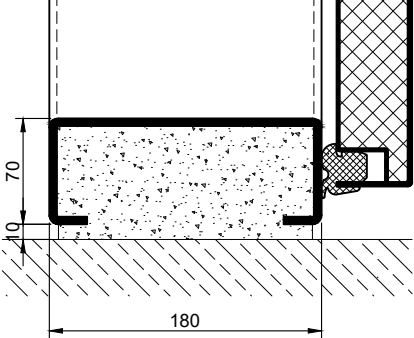
Frames	Thresholds	Options
<p>corner frame</p> 	<p>stop sill</p> 	<p>fastening device on hinge side</p> 
<p>encasing frame</p> 		
<p>block frame</p> 