

Double Leaf PLANE Line High-Frequency Shielding door for EMS, EMI and EMV applications

Shield Attenuation **40 to 80 dB** **tested acc. to IEEE 299**

protected by patents

Optional Audited Additional Functions

- Fire Protection	EI₂30/60/90-SaC5	tested acc. to EN 1634-1
- Smoke Control	RS (S₂₀₀)	tested acc. to EN 1634-3
- Burglar Protection	RC2/RC3/RC4/RC5	tested acc. to EN 1627
- Sound Insulation	up to R_{w,P} 54dB	tested acc. to EN ISO 10140-2
- Bullet Resistance	FB4/FB6-NS	tested acc. to EN 1522
- Air Tight	up to class 4	tested acc. to EN 1026
- Rain- and Fire-Water Tight	class 6A	tested acc. to EN 1027
- Wind load Resistance	up to class C5	tested acc. to EN 12211
- Blast Resistance	up to 20 kPa	tested acc. to EN 13124-1
- Explosion Protection	up to zone 1/21	acc. to EN 1127-1 or ATEX 2014/34/EU
- Stainless Steel		

Range of Dimension

Width from 1375 mm to 3000 mm
Height from 1750 mm to 3000 mm

Technical Specification and Tender Text

Product:	PL2 double leaf high-frequency shielding door brand Buchele
Door Type:	PLANE Line PL 2 PREMIUM
Shield Attenuation:	40 to 80 dB between 100 kHz and 10 GHz
Structural Opening: x mm
Door Leaf:	Double-walled, planar 70 mm thick steel door leaf without hinge embossing, three sides rebated with thick rebate and stainless steel contact bars at the bottom without stop with HF tow seal. Special insulating inserts fully laid-in and glued. Securing pin screwed in door leaf rebate. Passive leaf with multi-chamber sealing profile in the middle rebate and protected built-in HF spring contact bars.
Threshold:	Floor bracket as separation sill. Surface galvanized and welded to the frame.
Frame:	3-sided circumferential rebated corner frame High-quality multi chamber sealing profile adjustable fixed in the three-sided groove and protected built-in HF spring contact bars.
Hinges:	Three-part, height adjustable construction hinges with hinge pin retention and ball bearing spacer ring for smooth door movement.

Fitting:

Active leaf: mortise lock with latch lever function acc. to EN 12209 (prepared for installation of a profile cylinder lock, provided by customer)
Security door handle set in acc. to EN 1906 fixed pivoted, stainless steel, in U-shape with rounded long-plate.

Passive leaf with concealed shoot bolt lock.

Surface:

Door leaf and frame galvanized und primed with 2K-PUR primer (Very High Solid) similar RAL 7035.

Supplementary Equipment

Stainless Steel:

Material 1.4301 (V2A) or 1.4404 (V4A),
Surface mill finish or brushed.

BASIC Version

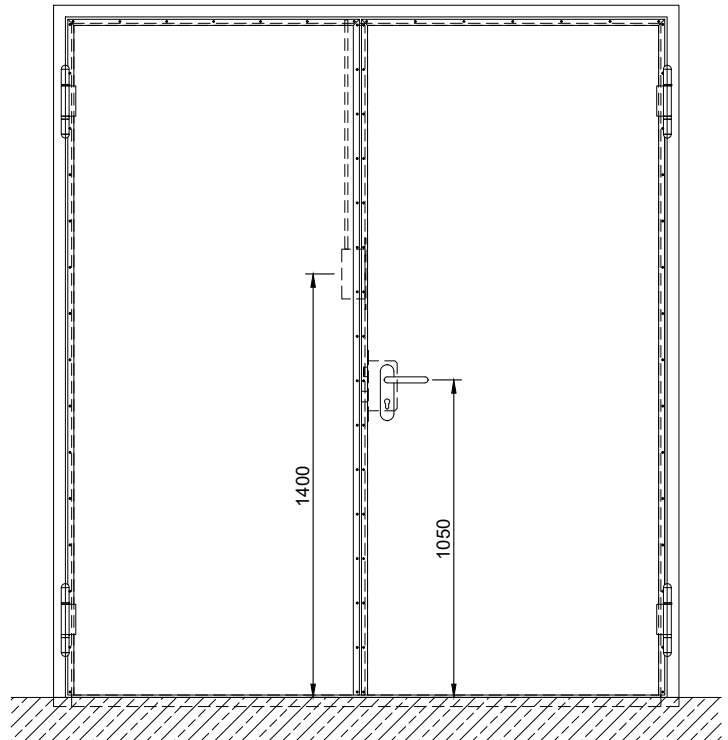
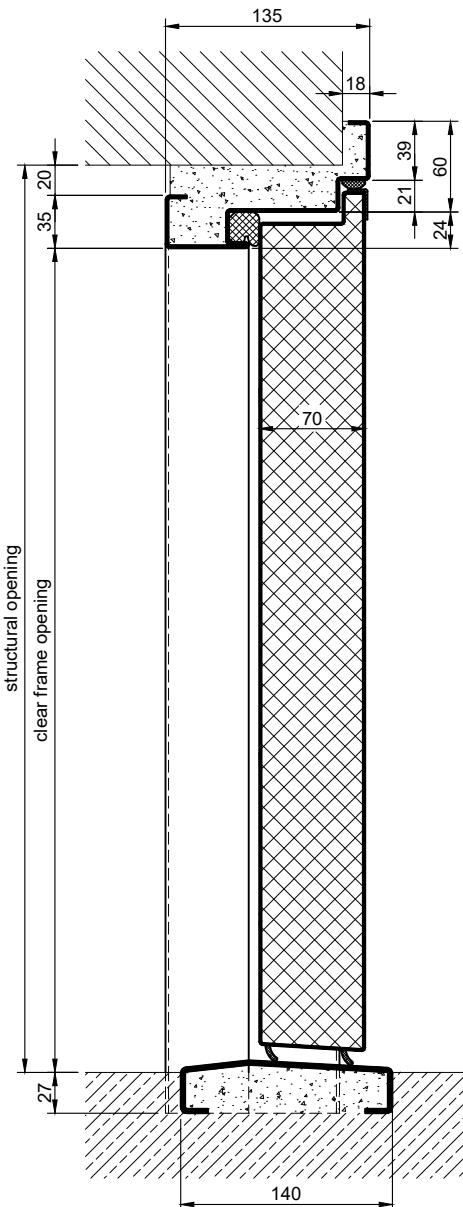
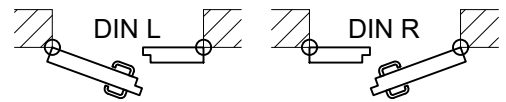
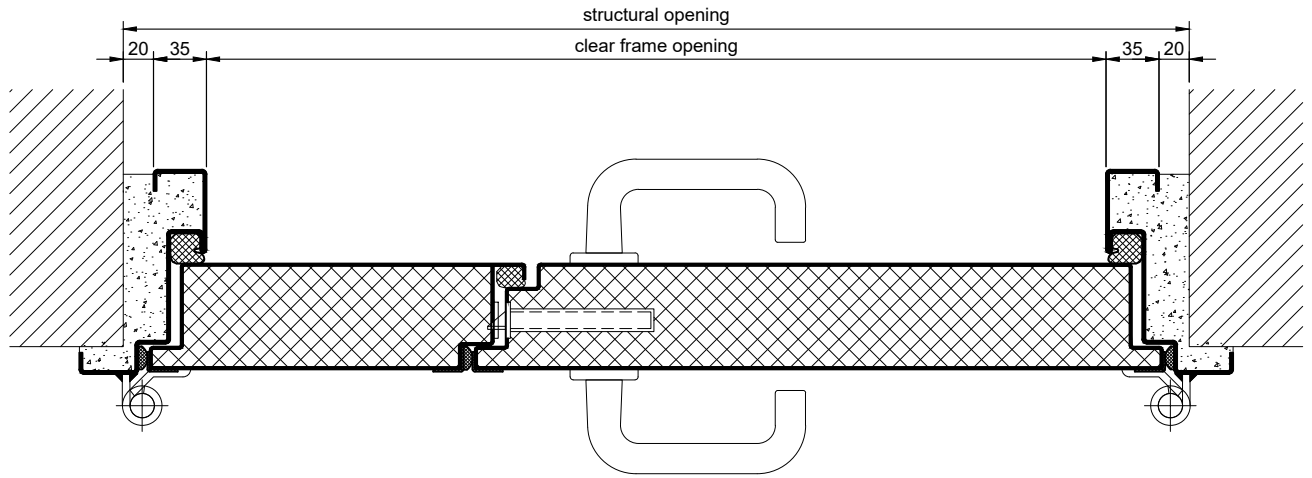

5.10.1_PLANE LINE PL 2 HF_EN

Frames		
<p>corner frame</p>		
<p>encasing frame</p>		
<p>block frame</p>		
<p>corner frame with counter frame</p>		
<p>profile block frame</p>		

5.10.1_PLANE LINE PL 2 HF_EN

technical modifications reserved - edition 07/2024