

Single Leaf FB7-NS Bullet Resistant Security Door with Fixed Glazing Side Panel as Tubular Frame Construction

Bullet Resistance **FB 7 NS** **tested acc. to EN 1522**

Range of Dimension Door

Width from 625 mm to 1500 mm
Height from 1750 mm to 3000 mm

Range of Dimension Side Panel

Width from 500 mm to 1500 mm
Height from 1750 mm to 3000 mm

Technical Specification and Tender Text

Product:	SEC1 single leaf bullet resistant security door with fixed glazing side panel brand Buchele tested acc. to EN 1522
Door Type:	SEC 1-R-ST / FB 7 NS
Bullet Resistance:	FB 7 NS
Structural Opening: x mm
Door Leaf:	116 mm thick steel door leaf, three sides rebated, border on three sides 105mm, border on lock side 155mm, BR7 safety glazing fixed with visible screwed steel glazing frame.
Threshold:	Stop sill. Surface galvanized.
Frame Door:	3-sided block frame with profile in the rebate.
Frame Side Panel:	3-sided block frame attached to the side of the door frame. With BR7 glazing fixed with profiled and visible screwed-on steel glazing frame .
Hinges:	Three-part construction hinges with ball bearing spacer ring.
Fitting:	Mortise lock with latch lever function (prepared for installation of a profile cylinder lock). Security door handle set, stainless steel, in U-shape with long-plate.
Surface:	Door leaf and frame galvanized und primed with 2K-PUR primer (Very High Solid) similar RAL 7035.

Supplementary Equipment

BUCHELE DELUXE: The exclusive surface coating.

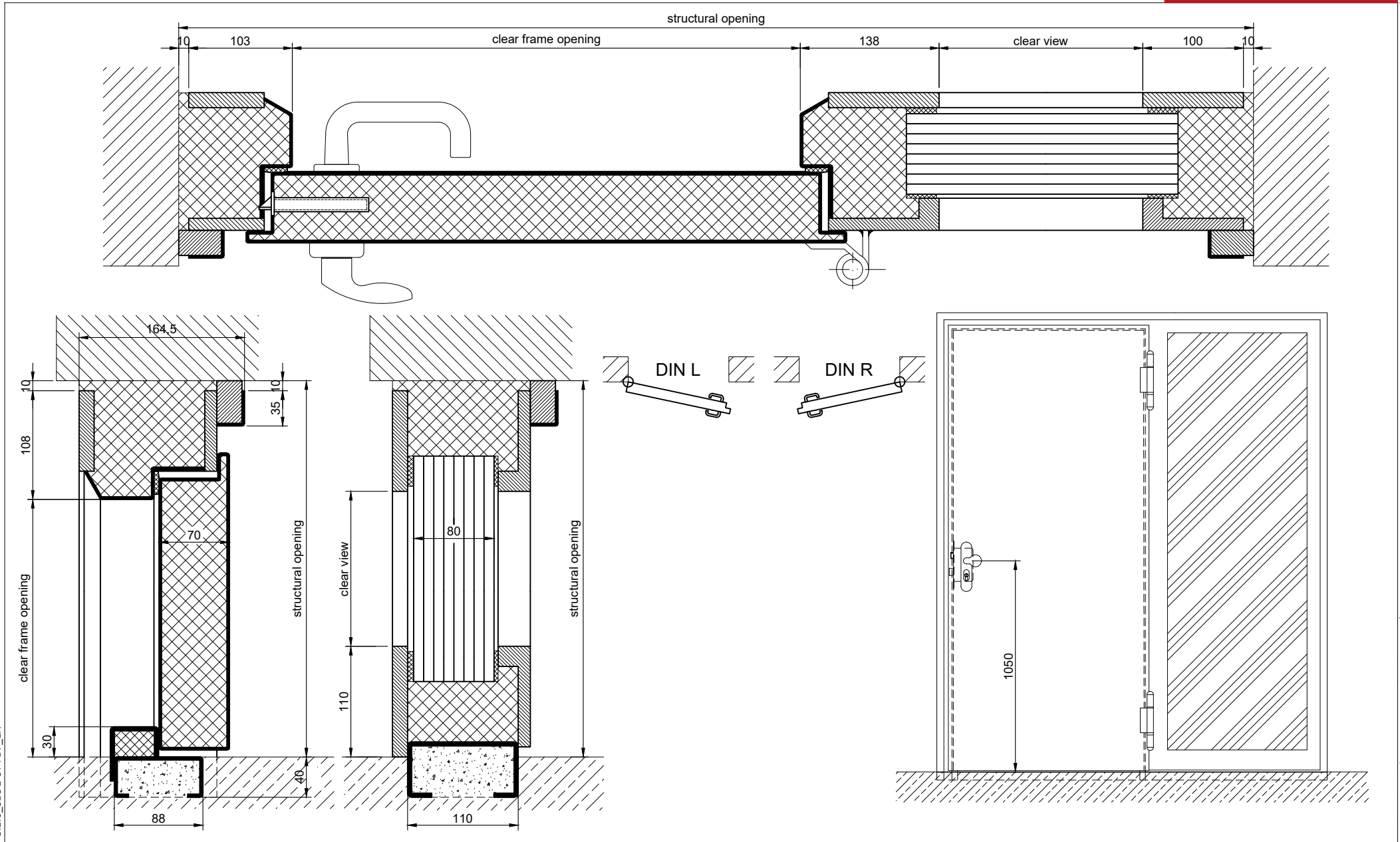

3.1.6_SEC1-ST_FB7_EN