

**Single Leaf FB7-NS Bullet Resistant Security Door with Fixed Glazing Side Panel**

**Bullet Resistance**                      **FB 7 NS**                      **tested acc. to EN 1522**

**Range of Dimension Door**

**Width** from 620 mm to 1500 mm  
**Height** from 1750 mm to 3000 mm

**Range of Dimension Side Panel**

**Width** from 500 mm to 1500 mm  
**Height** from 1750 mm to 3000 mm

**Technical Specification and Tender Text**

|                            |  |
|----------------------------|--|
| <b>Product:</b>            | <b>SEC1 single leaf bullet resistant security door with fixed glazing side panel brand Buchele tested acc. to EN 1522</b>  |
| <b>Door Type:</b>          | <b>SEC 1-ST / FB 7 NS</b>  |
| <b>Bullet Resistance:</b>  | <b>FB 7 NS</b>   |
| <b>Structural Opening:</b> | <b>.... x .... mm</b>  |
| <b>Door Leaf:</b>          | Double-walled, planar 70 mm thick steel door leaf, three sides rebated with thin rebate.<br>Special insulating inserts fully laid-in and glued.<br>Securing pin screwed in door leaf rebate.   |
| <b>Threshold:</b>          | Floor bracket as separation sill. Surface galvanized and welded to the frame.  |
| <b>Frame:</b>              | 3-sided circumferential rebated corner frame with high-quality multi chamber sealing profile adjustable fixed in the three-sided groove.   |
| <b>Hinges:</b>             | Three-part, height adjustable construction hinges with hinge pin retention and ball bearing spacer ring for smooth door movement.  |
| <b>Fitting:</b>            | 2-point security mortise lock with latch lever function acc. to EN 12209 (prepared for installation of a profile cylinder lock, provided by customer). Security door handle set acc. to EN 18257 fixed pivoted, stainless steel, in U-shape with rounded long-plate. |
| <b>Surface:</b>            | Door leaf and frame galvanized und primed with 2K-PUR primer (Very High Solid) similar RAL 7035.   |

**Supplementary Equipment**

|                        |  |
|------------------------|--|
| <b>Glazing:</b>        | BR7 single or insulating glazing fixed with profiled steel glazing bars. Minimum border 125 mm on side and top, base 300 mm. |
| <b>BUCHELE DELUXE:</b> | The exclusive surface coating.   |

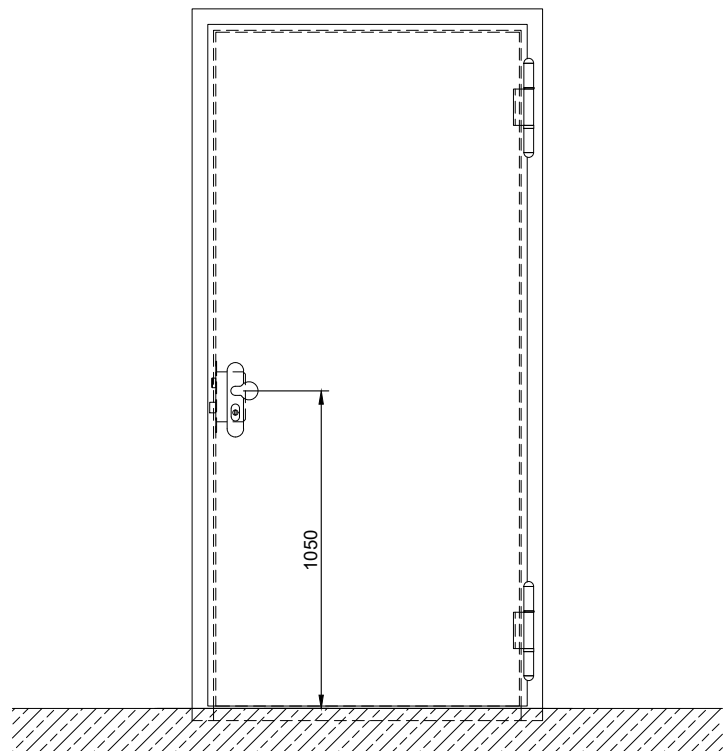
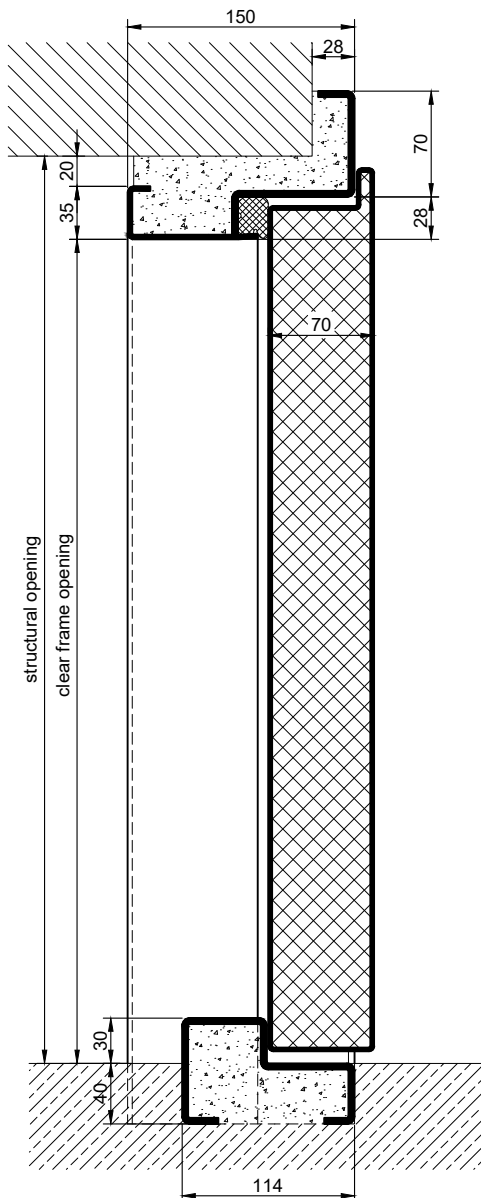
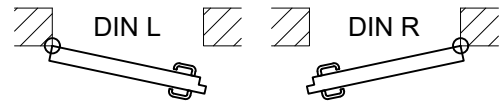
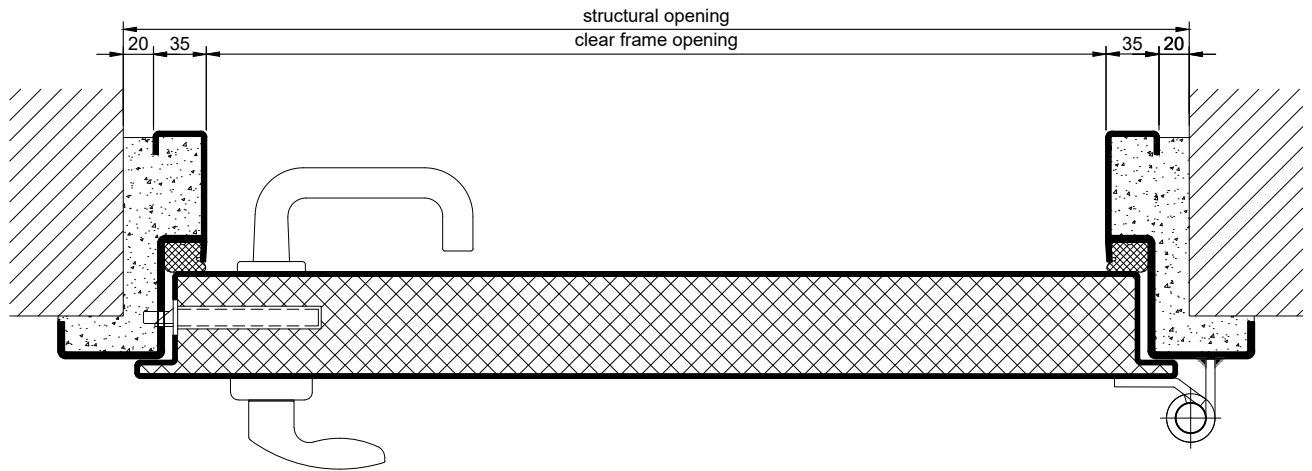

3.1.5\_SEC 1 FB7\_EN

technical modifications reserved - edition 06/2024

| Frames                | Schwellen   |  |
|-----------------------|---|--|
| <p>corner frame</p>   | <p>separation sill</p> <p>information:<br/>With this version there is <b>NO</b> bullet resistance in the threshold area!</p> <p>drop seal</p> <p>information:<br/>With this version there is <b>NO</b> bullet resistance in the threshold area!</p> |  |
| <p>encasing frame</p> | <p>stop sill without seal</p> <p>stop sill with seal</p>  |  |
| <p>block frame</p>    | <p>full sill</p>  |  |
| <b>Options</b>        |   |  |
| <p>glazing</p>        |   |  |

3.1.5\_SEC 1 FB7\_EN

technical modifications reserved - edition 06/2024