

## Single Leaf FB7-NS Bullet Resistant Security Door

**Bullet Resistance**                      **FB 7 NS**                      **tested acc. to EN 1522**

### Range of Dimension

**Width** from 500 mm to 1500 mm  
**Height** from 500 mm to 3000 mm

### Technical Specification and Tender Text

<b>Product:</b>	<b>SEC1 single leaf bullet resistant security door brand Buchele tested acc. to EN 1522</b>
<b>Door Type:</b>	<b>SEC 1 / FB 7</b>
<b>Bullet Resistance:</b>	<b>FB 7 NS</b>
<b>Structural Opening:</b>	<b>.... x .... mm</b>
<b>Door Leaf:</b>	Double-walled, planar 70 mm thick steel door leaf, three sides rebated with thin rebate. Special insulating inserts fully laid-in and glued. Securing pin screwed in door leaf rebate.
<b>Threshold:</b>	Floor bracket as separation sill. Surface galvanized and welded to the frame.
<b>Frame:</b>	3-sided circumferential rebated corner frame with high-quality multi chamber sealing profile adjustable fixed in the three-sided groove.
<b>Hinges:</b>	Three-part, height adjustable construction hinges with hinge pin retention and ball bearing spacer ring for smooth door movement.
<b>Fitting:</b>	2-point security mortise lock with latch lever function acc. to EN 12209 (prepared for installation of a profile cylinder lock, provided by customer). Security door handle set acc. to EN 18257 fixed pivoted, stainless steel, in U-shape with rounded long-plate.
<b>Surface:</b>	Door leaf and frame galvanized und primed with 2K-PUR primer (Very High Solid) similar RAL 7035.

### Supplementary Equipment

<b>Glazing:</b>	BR7 single or insulating glazing fixed with profiled steel glazing bars. Minimum border 125 mm on side and top, base 300 mm.
<b>BUCHELE DELUXE:</b>	The exclusive surface coating.

Frames	Schwellen	
<p>corner frame</p>	<p>separation sill</p> <p>information: With this version there is <b>NO</b> bullet resistance in the threshold area!</p>	<p>drop seal</p> <p>information: With this version there is <b>NO</b> bullet resistance in the threshold area!</p>
<p>encasing frame</p>	<p>stop sill without seal</p>	<p>stop sill with seal</p>
<p>block frame</p>	<p>full sill</p>	
<h3>Options</h3>		
<p>glazing</p>		

3.1.5\_SEC 1 FB7\_EN

technical modifications reserved - edition 06/2024

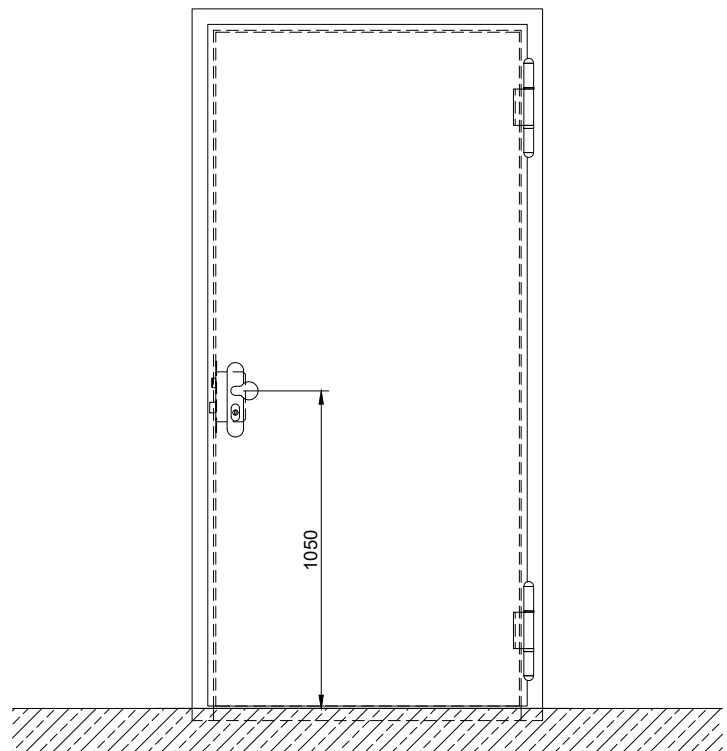
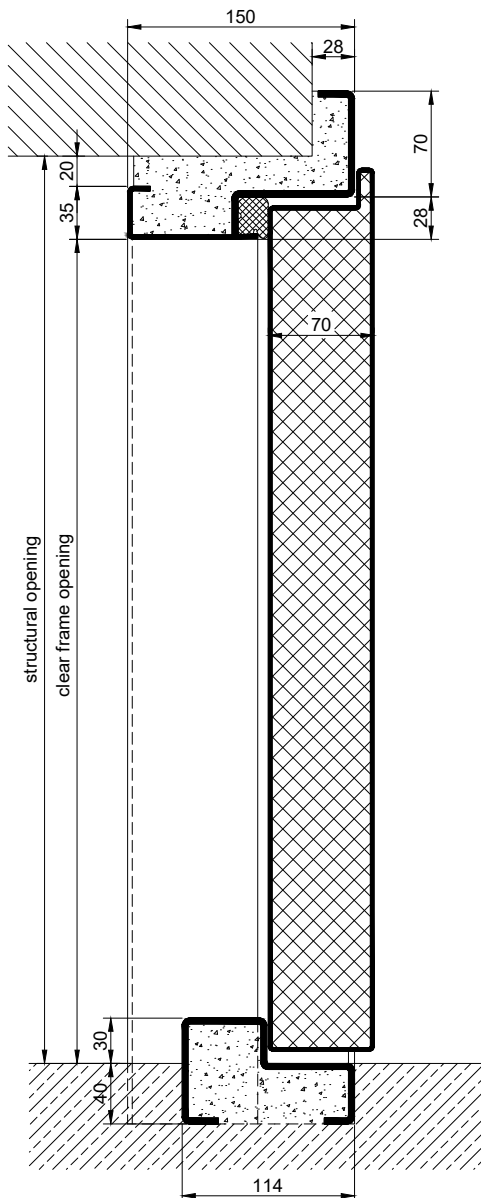
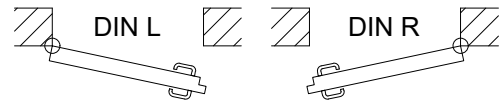
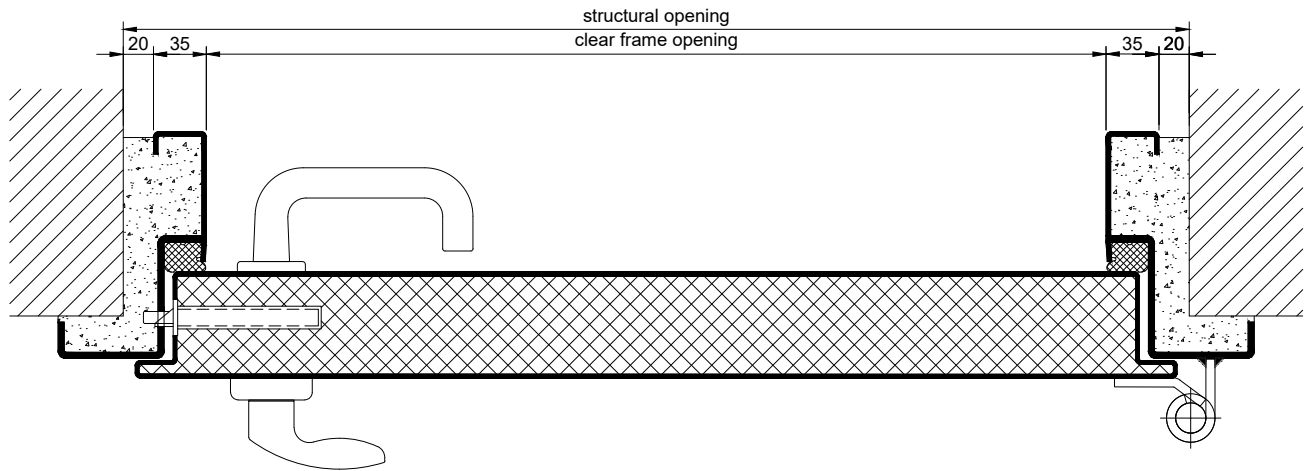

3.1.5\_SEC 1 FB7\_EN

technical modifications reserved - edition 06/2024