

Single Leaf SEC 11 / RC6 Burglar Resistant Security Door

Burglar Protection **RC6** **tested acc. to EN 1627**

Range of Dimension

Width from 675 mm to 1250 mm
Height from 750 mm to 2250 mm

Technical Specification and Tender Text

Product:	SEC single leaf security door brand Buchele tested acc. to EN 1627
Door Type:	SEC 11 / RC 6
Resistance Class:	RC6
Structural Opening: x mm
Door Leaf:	Double-walled, planar 64 mm thick steel door leaf, three sides rebated with thin rebate. Without bottom stop. Special insulating inserts fully laid-in and glued. Securing pin screwed in door leaf rebate.
Threshold:	Floor bracket as separation sill. Surface galvanized and welded to the frame.
Frame:	3-sided circumferential rebated corner frame High-quality multi chamber sealing profile adjustable fixed in the three-sided groove.
Hinges:	Three-part, height adjustable construction hinges with hinge pin retention and ball bearing spacer ring for smooth door movement.
Fitting:	6-point security mortise lock with latch lever function acc. to EN 12209 (prepared for installation of a profile cylinder lock, provided by customer) Special security door handle set fixed pivoted, stainless steel, in U-shape with square long-plate.
Surface:	Door leaf and frame galvanized und primed with 2K-PUR primer (Very High Solid) similar RAL 7035.

Supplementary Equipment

Stainless Steel:	Material 1.4301 (V2A) or 1.4404 (V4A), Surface mill finish or brushed.
BUCHELE DELUXE:	The exclusive surface coating.

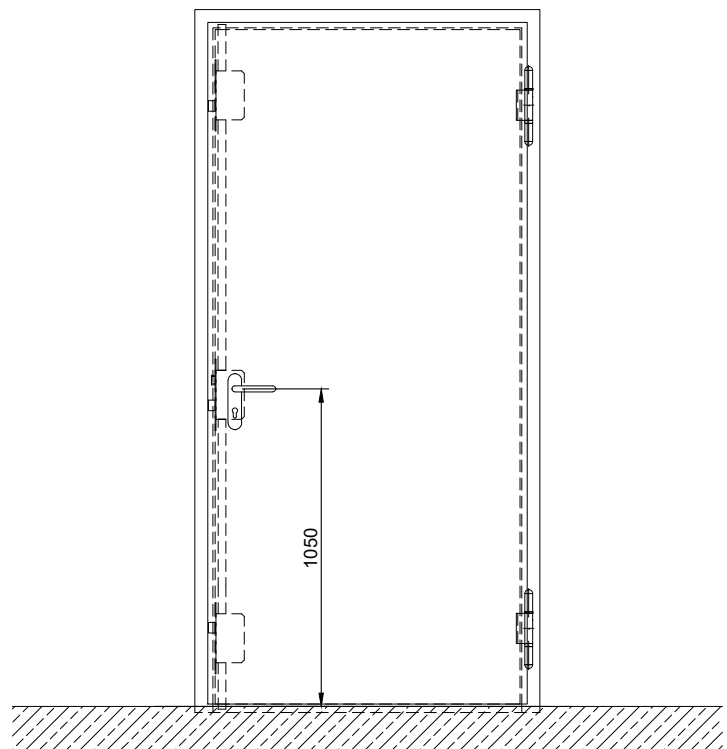
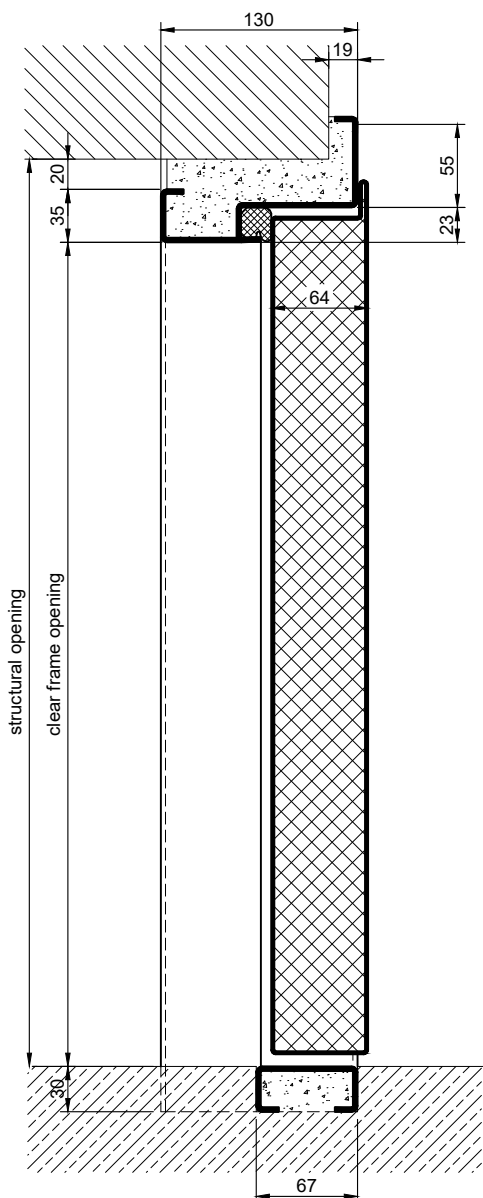
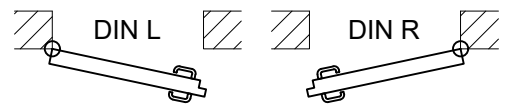
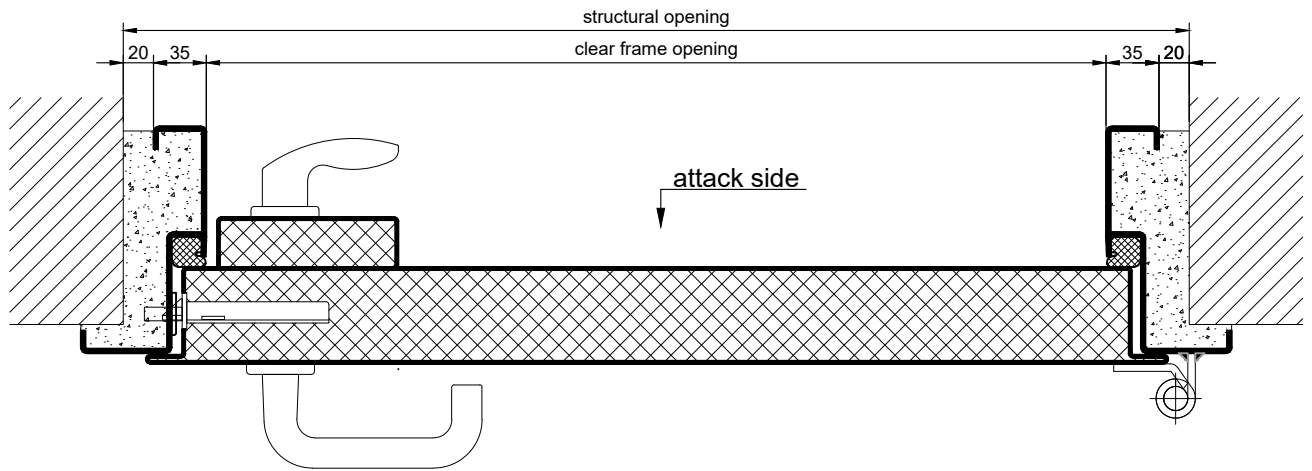

3.0.6_SEC11_RC6_EN

technical modifications reserved - edition 06/2024

Frames

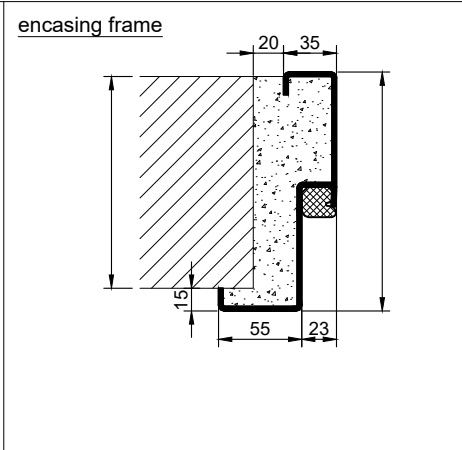
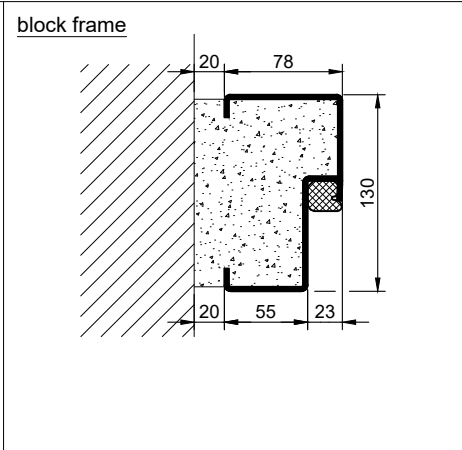
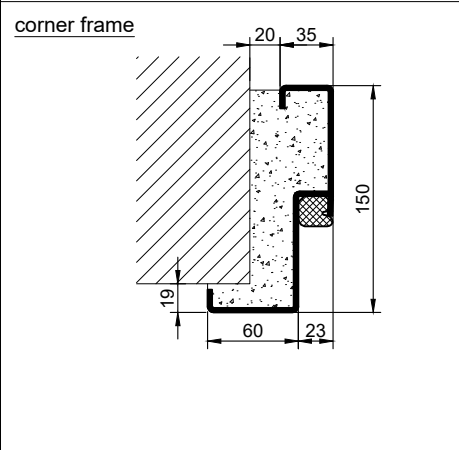

Thresholds

