

Double Leaf High Sound Insulating STB POWER Steel Door

Sound Insulation $R_{w,P}$ **60 dB** tested acc. to EN ISO 10140-2

Optional Audited Additional Functions

- Bullet Resistance	FB4, FB6, FB7-NS	tested acc. to EN 1522
- Air Tight	up to class 4	tested acc. to EN 1026
- Rain- and Fire-Water Tight	class 6A	tested acc. to EN 1027
- Wind Load Resistance	class C5	tested acc. to EN 12211
- Blast Resistance	up to 20 kPa	tested acc. to EN 13124-1
- Explosion Protection	up to zone 1/21	acc. to EN 1127-1 or ATEX 2014/34/EU
- Stainless Steel		

Range of Dimension

Width from 1375 mm to 4000 mm *oversize is possible
Height from 1750 mm to 4000 mm

Technical Specification and Tender Text

Product: STB 60-2 double leaf high sound insulating steel door brand Buchele tested acc. to EN ISO 10140-2

Door Type: STB -2 POWER Line

Sound Insulation $R_{w,P}$ 60 dB

Structural Opening: x mm

Door Leaf: Double-walled, planar 95 mm thick steel door without hinge embossing, three sides rebated with thick rebate and adjustable fixed sealing profile in the rebate.
 Special insulating inserts fully laid-in and glued.
 Passive leaf with multi-chamber sealing profile in the middle rebate.
 Double tow sealing system.
 Passive leaf with multi-chamber sealing profile in the middle rebate.

Threshold: Threshold profile as barrier-free hump sill. Surface galvanized and welded to the frame.

Frame: 3-sided circumferential rebated corner frame
 High-quality multi chamber sealing profile adjustable fixed in the three-sided groove.

Hinges: Three-part, height adjustable construction hinges with hinge pin retention and ball bearing spacer ring for smooth door movement.

Fitting: **Active leaf** with heavy-duty worm clamping locking device with solid locking worm, spring-suspended lock latch and automatic maloperation interlock system.
 Lock prepared for installation of a profile cylinder, provided by customer.
 Reinforced clamping lever pair, ergonomically shaped, fixed pivoted on squared long platers, visible screwed to the door leaf. Surface stainless steel with black lever handle area.
Passive leaf with surface-mounted 2-point locking system operated by an espagnolette bolt with loop handle.

Surface: Door leaf and frame galvanized und primed with 2K-PUR primer (Very High Solid) similar RAL 7035.

Supplementary Equipment

Glazing: On request

Stainless Steel: Material 1.4301 (V2A) or 1.4404 (V4A),
Surface mill finish or brushed.

Air Lock: Air Lock Soil Liner System (pneumatic sealing system to the floor).
Automatic lifting and lowering of the bottom seal when actuating the clamping levers.

BUCHELE DELUXE: The exclusive surface coating.

Panic: Worm clamping locking device with integrated emergency release function. (The locked and fastened door leaf locking can be unlocked and opened with only two movements without using the locking cylinder.)

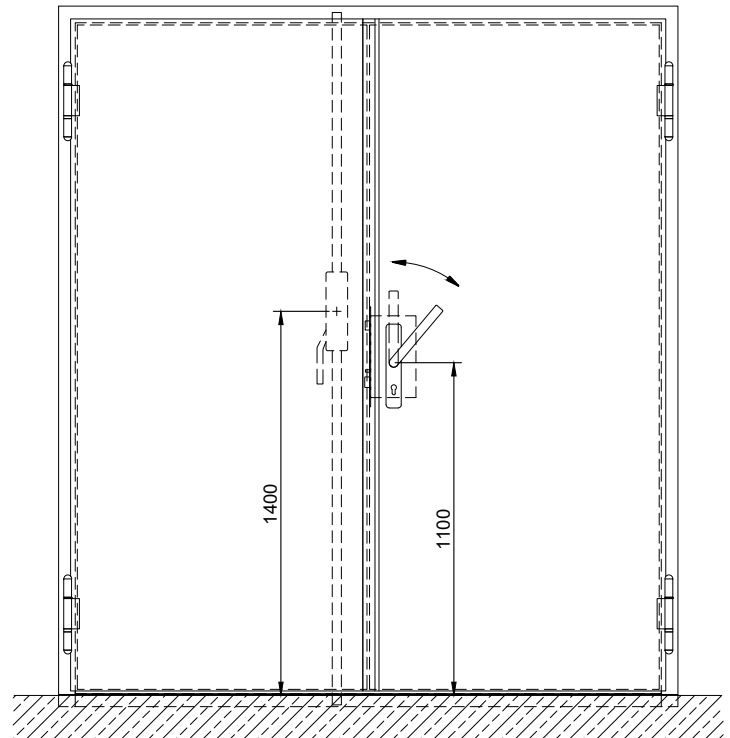
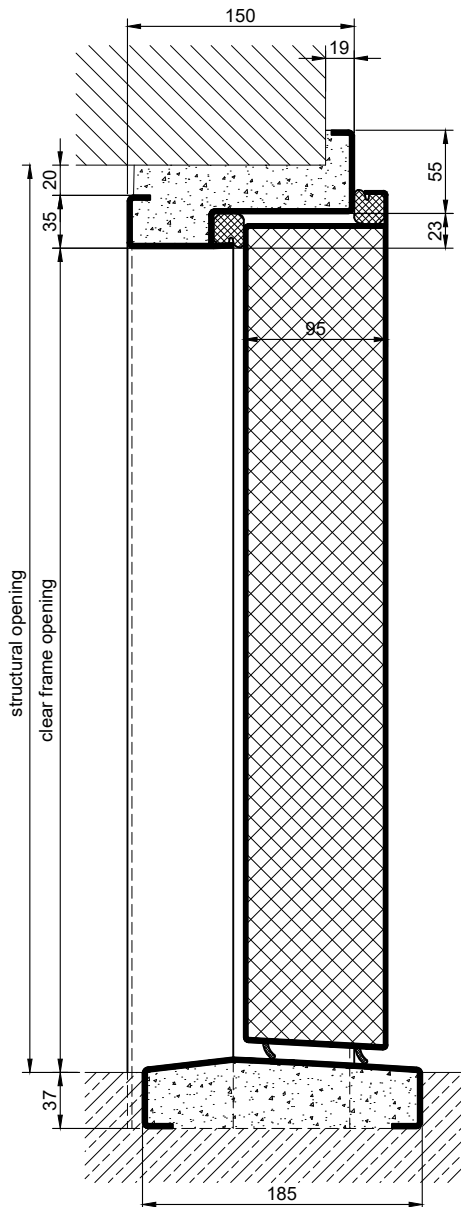
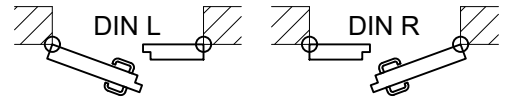
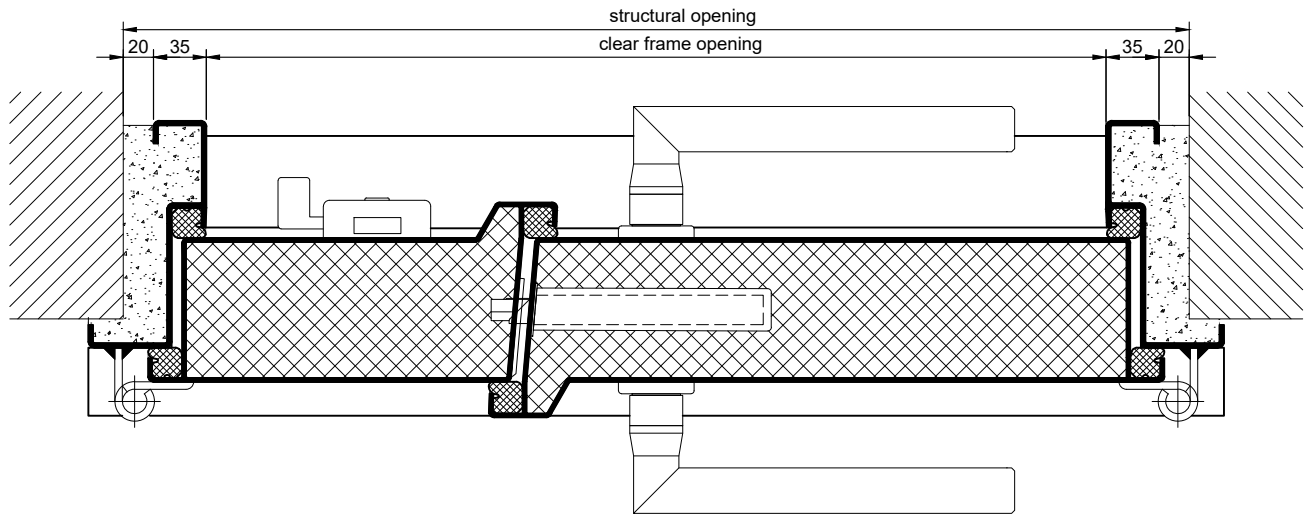

2.12.5_STB 60-2 POWER LINE_EN

technical modifications reserved - edition 05/2024

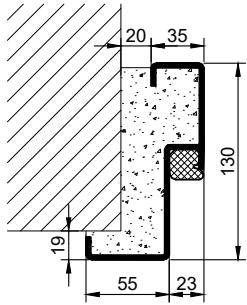
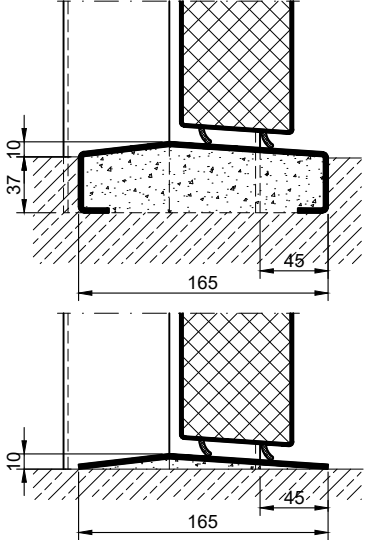
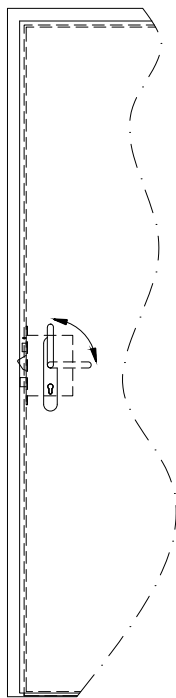
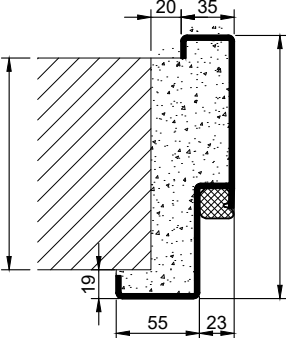
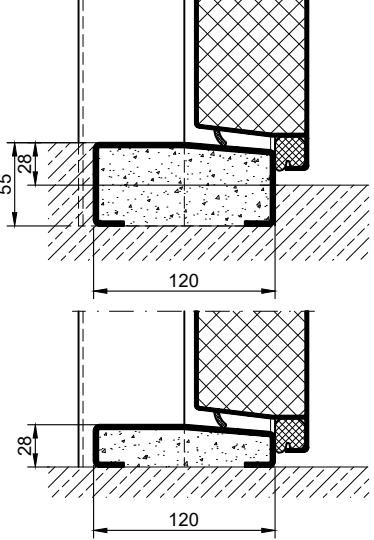
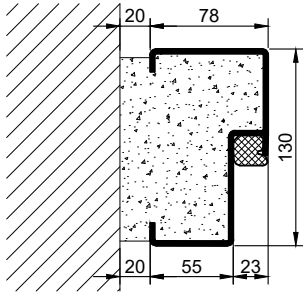
Frames	Thresholds	Options
<p><u>corner frame</u></p> 	<p><u>hump sill</u></p> 	<p><u>Buchele wedge latch lock</u></p> 
<p><u>encasing frame</u></p> 	<p><u>half sill</u></p> 	
<p><u>block frame</u></p> 	<p><u>full sill</u></p> 